

# SECTION 1 ROTARY VALVES

## Accessories – Rotary Valve Feeder Inlet Hopper

### PRODUCT FEATURES

- Constructed of aluminum, carbon steel or 304 stainless steel
- Isolated chamber vents rotary feeder "blow-by" air away from product feed, and prevents material bridging
- Dust laden "blow-by" air can be evacuated by existing dust collection systems, sock type filter, or stand alone reverse pulse jet unit
- May be used with one (1) or two (2) rotary valves

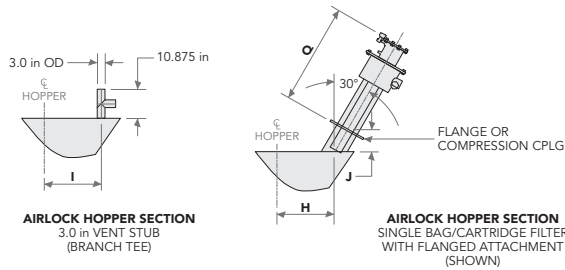
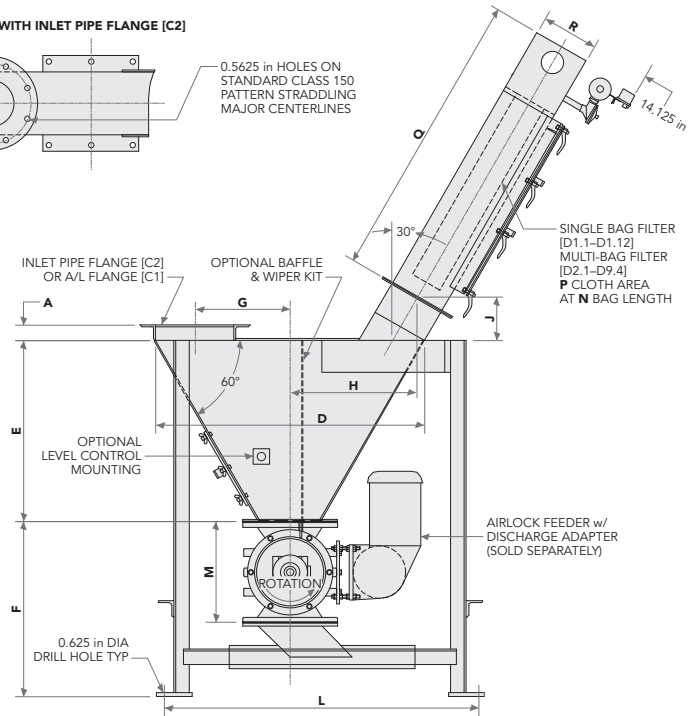
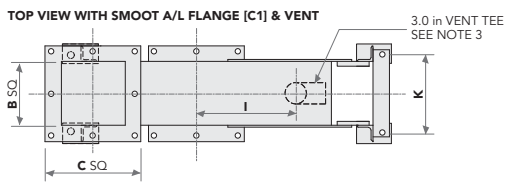
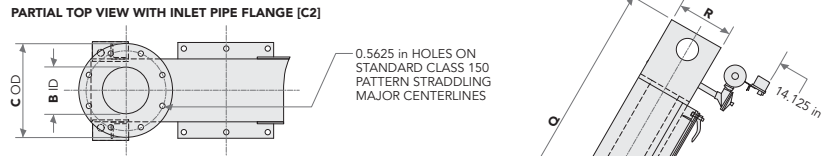
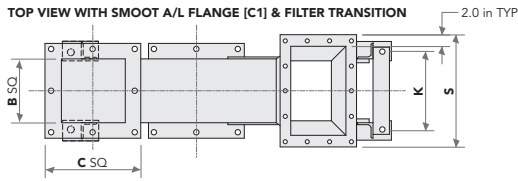

**Rotary Valve Feeder Inlet Hopper Dimensions (inches)**

ROTARY VALVE FEEDER SIZE	NUMBER OF BAGS	INLET FLANGES							D	E	F	G		H	I	J	K	L	M
		Pipe Flange			Smoot A/L Flange							A/L Flange	Pipe Flange						
		SIZE	A	B	C	A	B	C											
FT7	1	5	3-9/16	5	10	2-1/2	6-1/4	11-1/4	24-1/2	16-1/8	19	9-1/4	8-1/4	11-1/2	9	7-5/16	8-1/4	34-5/8	9-7/8
FT9	1	6	3-11/16	6	11	2	8-1/4	12-1/4	34	23	22	13-1/4	12	16-1/4	7-1/4	7-5/16	10-1/4	40-3/8	12-1/2
FT11	1	8	3-7/8	8	13-1/2	2	9-1/4	13-1/4	38-7/16	26	25	14-3/4	13-1/4	18-1/2	8-1/4	7-5/16	11-1/4	44-1/4	14-5/8
FT12	1	8	3-7/8	8	13-1/2	2-1/2	10-1/4	15-1/4	38-1/2	25	28	11-3/4	13-1/4	18-1/2	7-1/4	7-5/16	12-1/4	44-3/4	15-3/4
	17-9/16													7-1/16					
	17-1/2													13-1/16					
FT14	2	10	4-1/16	10	16	2-1/2	12-1/4	17-1/4	42-5/16	26-3/8	31-7/8	15-3/16	14-3/16	18-5/8	6-15/16	5-1/2	14-1/4	46-3/4	17-5/8
	3													20-1/4		11-9/16			
	4													16		7			
FT16	2	12	4-5/16	12	19	2-1/2	13-1/4	18-1/4	42-11/16	26	35-1/2	12-3/8	14-3/8	18-3/8	6-1/4	4-3/4	16-1/4	53-5/8	19-5/8
	3													20-15/16		10-3/4			
	4													15-3/4		6-1/4			
FT18	3	14	4-3/8	14	21	2-1/2	15-1/4	20-1/4	45-1/4	26-3/16	41-5/16	15-1/8	14-5/8	22-1/4	5-11/32	9-5/16	18-1/4	57-1/4	21-3/4
	4													17-7/16		7			
	6													19-5/8		10-13/16			
FT22	4	16	4-9/16	16	23-1/2	3	16-1/4	22-1/4	46-1/2	26-7/16	43-9/16	14-5/8	14-1/4	18-1/16	5	7	19-1/4	59-1/2	25-7/8
	6													19-1/16		10-1/16			
FT30	6	20	5	20	27-1/2	4	23-1/4	31-1/4	56-15/16	29-3/8	65-1/2	17	17-1/2	23-5/16	3	7	27-1/4	76-1/4	37
	9													19-7/8		9			

### SAFETY NOTICE

Design Engineers • Technicians • Installers

### SAFETY NOTICE

The inlet and outlet of the rotary valve must have proper attachments to prevent anyone from being able to insert their hands, or foreign objects, into the valve when in operation.